

**vtech**<sup>®</sup>

User's Manual

# Spin Around Learning Town™



© 2008 VTech

Printed in China

91-028900-000-006 (美)

Dear Parent,

Ever notice the look on your baby's face when they learn something new through their own discovery? These self-accomplished moments are a parent's greatest reward. To help fulfill them, **VTech**<sup>®</sup> created the **Infant Learning**<sup>®</sup> series of toys.

These unique interactive learning toys directly respond to what children do naturally – play! Using innovative technology, these toys react to baby's interactions, making each play experience fun and unique as they learn age-appropriate concepts like first words, numbers, shapes, colors and music. More importantly, **VTech**<sup>®</sup>'s **Infant Learning**<sup>®</sup> toys develop baby's mental and physical abilities by inspiring, engaging and teaching.

At **VTech**<sup>®</sup>, we know that a child has the ability to do great things. That's why all of our electronic learning products are uniquely designed to develop a child's mind and allow them to learn to the best of their ability. We thank you for trusting **VTech**<sup>®</sup> with the important job of helping your child learn and grow!

Sincerely,

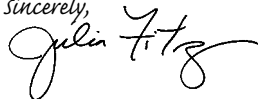

Julia Fitzgerald  
Vice President, Marketing  
Vtech Electronics, NA

To learn more about the **Infant Learning**<sup>®</sup> and other **VTech**<sup>®</sup> toys, visit [www.vtechkids.com](http://www.vtechkids.com)

# INTRODUCTION

Thank you for purchasing the **VTech® Spin Around Learning Town™** learning toy!

The **VTech® Spin Around Learning Town™** is an electronic learning toy for toddlers 12 months and up. Toddlers can explore the town with three playful and interactive sides. The farm side has 5 brightly colored piano keys, a flashing sun and playful rooster. The backyard has a sliding peek-a-boo window, swing and a turning book page. Inside the house is an interactive clock, sliding window and sliding beads. There is plenty for curious little minds to explore.

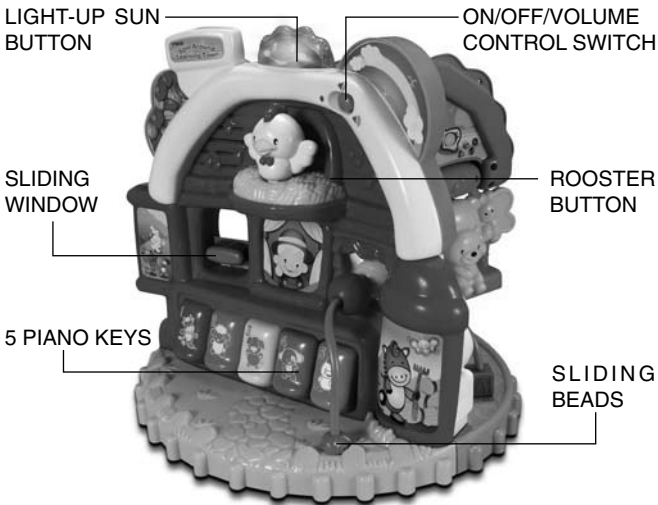

TURNING CLOCK

SWINGING BEAR

SLIDING BEADS

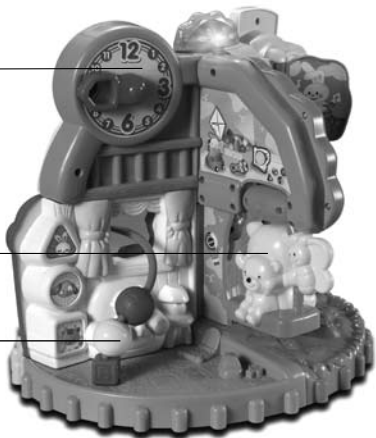

TURNING BOOK PAGE

SLIDING WINDOW

SWINGING BEAR



# INCLUDED IN THIS PACKAGE

- One VTech® Spin Around Learning Town™ learning toy  
(Includes main unit, side panel, base and bead track)
- One instruction manual

**INSTRUCTION:**All packing materials, such as tape, plastic sheets, wire ties and tags are not part of this toy, and should be discarded for your child's safety.

## GETTING STARTED

### BATTERY INSTALLATION

1. Make sure the unit is turned OFF.
2. Locate the battery cover on the side of the unit. Use a coin or a screwdriver to loosen the screw.
3. Install 2 new 'AA' (AM-3/LR6) batteries following the diagram inside the battery box. (The use of new alkaline batteries is recommended for maximum performance.)
4. Replace the battery cover and tighten the screw to secure the battery cover.

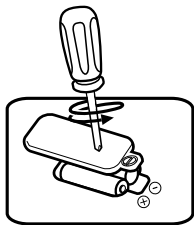

### BATTERY NOTICE

- Install batteries correctly observing the polarity (+, -) signs to avoid leakage.
- Do not mix old and new batteries.
- Do not mix batteries of different types: alkaline, standard (carbon-zinc) or rechargeable (nickel-cadmium).

- Remove the batteries from the equipment when the unit will not be used for an extended period of time.
- Always remove exhausted batteries from the equipment.
- Do not dispose of batteries in fire.
- Do not attempt to recharge ordinary batteries.
- The supply terminals are not to be short-circuited.
- Only batteries of the same and equivalent type as recommended are to be used.

**WE DO NOT RECOMMEND THE USE OF RECHARGEABLE BATTERIES.**

## ASSEMBLY INSTRUCTIONS

1. Insert the side panel with the swinging bear into the main unit and snap into place to secure.

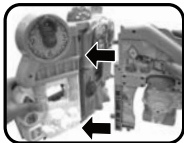

2. Insert the main unit into the base unit and snap into place to secure.

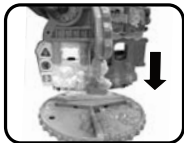

3. Slide the bead track through the window. Snap the red block end into the home side, then snap the green grass end into the farm side.

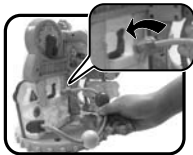

# PRODUCT FEATURES

## 1. ON/OFF/VOLUME CONTROL SWITCH

To turn the unit **ON**, slide the **ON/OFF/VOLUME CONTROL SWITCH** to the **LOW VOLUME** (🔊) or **HIGH VOLUME** (🔊) position.

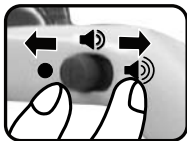

To turn the unit **OFF**, slide the **ON/OFF/VOLUME CONTROL SWITCH** to the **OFF** (●) position.

## 2. AUTOMATIC SHUT-OFF

To preserve battery life, the **VTech® Spin Around Learning Town™** will automatically power-down after approximately 25 seconds without input. The unit can be turned on again by pressing any button.

# ACTIVITIES

1. Slide the **on/off/volume control switch** to turn the unit on. You will hear a fun song and a welcoming phrase. The light will flash with the sound.

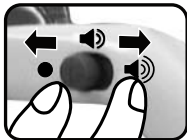

2. Press the **rooster button** to hear a variety of sounds, phrases, a short tune or a song. While the song is playing, press the piano keys to play music notes. The piano keys will resume normal play when any other button is pressed. The light will flash with the sound.

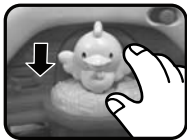

3. Press the **light-up sun button** to hear playful phrases, sounds and short tunes. The light will flash with the sound.



4. Press the **piano keys** to learn about numbers, animals, colors and hear fun sounds and short tunes. The light will flash with the sound.



5. Slide the **beads** through the window to hear numbers and fun sounds. The light will flash with the sound.

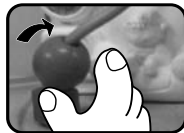

6. Slide the **window** to hear a variety of peek-a-boo phrases and fun sounds. The light will flash with the sound.

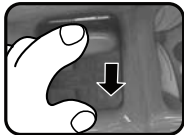

7. Turn the **clock hands** to learn about four different times of day. The light will flash with the sound.

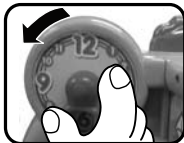



8. Push the **swinging bear** to hear playful sounds, a fun phrases or a song. The light will flash with the sound.

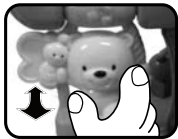

9. Flip the turning **book page** to hear short nursery rhymes. The light will flash with the sound.

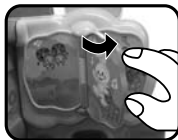

10. Spin the town to hear random melodies, sounds and a phrase. The light will flash with the sound.

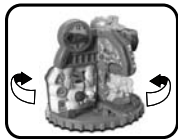

11. If there is no input to the unit after approximately 8 seconds, you will hear a short phrase and a random melody. After another 8 seconds if there is still no input, you will hear a random song. After another 8 seconds if there continues to be no input, the unit will automatically power-down.



# MELODY LIST

1. Old MacDonald Had a Farm
2. Farmer in the Dell
3. Here We Go Round the Mulberry Bush
4. Home on the Range
5. Turkey in the Straw

# SUNG SONG LYRICS

## **SONG 1** (To the tune of “Aiken Drum”)

We like to play out in the yard, on the farm and in the house.  
We like to play with all our friends and we have a lot of fun!

## **SONG 2** (To the tune of “Mary, Mary, Quite Contrary”)

Mary, Mary, quite contrary,  
How does your garden grow?

## **SONG 3** (To the tune of “Ring Around the Rosy”)

Ring around the rosy,  
Pockets full of posies.  
Hush-a, hush-a, we all fall down.

# CARE & MAINTENANCE

1. Keep the unit clean by wiping it with a slightly damp cloth.
2. Keep the unit out of direct sunlight and away from any direct heat source.
3. Remove the batteries when the unit is not in use for an extended period of time.
4. Do not drop the unit on hard surfaces and do not expose the unit to moisture or water.

# TROUBLESHOOTING

If for some reason the program/activity stops working, please follow these steps:

1. Please turn the unit OFF.
2. Interrupt the power supply by removing the batteries.
3. Let the unit stand for a few minutes, then replace the batteries.
4. Turn the unit ON. The unit should now be ready to play again.
5. If the product still does not work, replace with an entire set of new batteries.

If the problem persists, please call our Consumer Services Department at 1-800-521-2010 in the U.S. or 1-877-352-8697 in Canada, and a service representative will be happy to help you.

Caution : changes or modifications not expressly approved by the party responsible for compliance could void the user's authority to operate the equipment.

THIS DEVICE COMPLIES WITH PART 15 OF THE FCC RULES. OPERATION IS SUBJECT TO THE FOLLOWING TWO CONDITIONS: (1) THIS DEVICE MAY NOT CAUSE HARMFUL INTERFERENCE, AND (2) THIS DEVICE MUST ACCEPT ANY INTERFERENCE RECEIVED, INCLUDING INTERFERENCE THAT MAY CAUSE UNDESIRE OPERATION.

THIS CLASS B DIGITAL APPARATUS COMPLIES WITH CANADIAN ICES-003.

CET APPAREIL NUMÉRIQUE DE LA CLASSE B EST CONFORME À LA NORME NMB-003 DU CANADA.

### IMPORTANT NOTE:

Creating and developing Infant Learning products is accompanied by a responsibility that we at **VTech®** take very seriously. We make every effort to ensure the accuracy of the information, which forms the value of our products. However, errors sometimes can occur. It is important for you to know that we stand behind our products and encourage you to call our Consumer Services Department on at 1-800-521-2010 in the U.S. or 1-877-352-8697 in Canada, with any problems and/or suggestions that you might have. A service representative will be happy to help you.

### Note:

This equipment has been tested and found to comply with the limits for a Class B digital device, pursuant to Part 15 of the FCC Rules. These limits are designed to provide reasonable protection against harmful interference in a residential installation. This equipment generates, uses and can radiate radio frequency energy and, if not installed and used in accordance with the instructions, may cause harmful interference to radio communications. However, there is no guarantee that interference will not occur in a particular installation. If this equipment does cause harmful interference to radio or television reception, which can be determined by turning the equipment off and on, the user is encouraged

to try to correct the interference by one or more of the following measures:

- Reorient or relocate the receiving antenna
  - Increase the separation between the equipment and receiver
  - Connect the equipment into an outlet on a circuit different from that to which the receiver is connected
  - Consult the dealer or an experienced radio/TV technician for help
- measures: